

Silicone Hydrocellular Dressings



Device description:

- **ESPUMA® GENTLE** is absorbent wound dressing made of polyurethane foam. The outermost layer is bacteria-proof, virus-proof and waterproof polyurethane film. The wound contact layer is perforated soft silicone gel that allows painless and atraumatic removal and permits the passage of exudate to the absorbent foam layer.
- **ESPUMA® GENTLE LITE** differs in having a thinner polyurethane foam layer.
- **ESPUMA® GENTLE COMFORT** differs in having an additional adhesive outermost PU border, so the dressing can be applied without fixation tape or secondary dressing.
- **ESPUMA® GENTLE LITE COMFORT** has a thin polyurethane foam layer, nonwoven distribution layer with an adhesive outermost PU border.
- **ESPUMA® GENTLE LITE COMFORT FLEX** has a thin polyurethane foam layer, symmetrically perforated nonwoven distribution layer with an adhesive outermost PU border.
- **ESPUMA® GENTLE XTRA COMFORT** consists of five layers: polyurethane foam, nonwoven distribution layer and highly absorbent pad made of superabsorbent fibres with an adhesive outermost PU border.
- **ESPUMA® GENTLE XTRA COMFORT FLEX** consists of five layers: polyurethane foam, nonwoven distribution layer and highly absorbent pad made of superabsorbent fibres symmetrically perforated providing channels to allow higher absorption capacity for exudates, with an adhesive outermost PU border.
- **ESPUMA® GENTLE TRANSFER** is composed of thin polyurethane foam layer, but without polyurethane top sheet, so that the dressing can transfer exudates away from the wound into a secondary absorbent dressing.

Intended purpose:

Silicone Hydrocellular Dressings are intended to assist healing of different types of wounds, burns and skin related diseases and conditions.

Variant	Indication
ESPUMA® GENTLE	<ul style="list-style-type: none"> - Shallow, granulating wounds - Chronic and acute exudative wounds - Full and partial thickness wounds such as pressure ulcers, leg ulcers and diabetic foot ulcers - Infected wounds - Malignant wounds - Surgical wounds - First and second-degree burns - Donor sites - Skin tears - Fungating ulcers - Can also be used as a protection of compromised and/or fragile skin e.g. Epidermolysis Bullosa patients

Silicone Hydrocellular Dressings

<p>ESPUMA® GENTLE COMFORT</p>	<p>Wound management on shallow, granulating wounds, chronic and acute exudative wounds, full and partial thickness wounds including:</p> <ul style="list-style-type: none"> - Pressure ulcers - Leg ulcers - Diabetic Foot Ulcers - Surgical wounds - First and second-degree burns - Donor sites - Skin tears - Fungating ulcers
<p>ESPUMA® GENTLE LITE</p>	<p>Used in management of a wide range of non to low exuding wounds such as:</p> <ul style="list-style-type: none"> - Leg and foot ulcers - Pressure injuries - Partial thickness burns - Radiation skin reactions - Can also be used as a protection of compromised and/or fragile skin e.g. Epidermolysis Bullosa patients.
<p>ESPUMA® GENTLE LITE COMFORT</p> <p>ESPUMA® GENTLE LITE COMFORT FLEX</p>	<p>Designed for the management of a wide range of non/low exuding wounds:</p> <ul style="list-style-type: none"> - Leg and foot ulcers - Pressure ulcers - Surgical and Traumatic wounds as: abrasions, blisters and skin tears - Can also be used as protection of compromised and/or fragile skin e.g. Epidermolysis Bullosa patients.
<p>ESPUMA® GENTLE XTRA COMFORT</p> <p>ESPUMA® GENTLE XTRA COMFORT FLEX</p>	<ul style="list-style-type: none"> - Leg and foot ulcers - Pressure injuries - Traumatic wounds (eg. Skin tears) - Surgical wounds - Can be used on dry/necrotic wounds in combination with gels (Cavidagel®) - Reduces postoperative blistering, and may also be used as part of a prophylactic therapy to help prevent skin damage, e.g. pressure ulcers.
<p>ESPUMA® GENTLE TRANSFER</p>	<ul style="list-style-type: none"> - Designed for a wide range of exuding and difficult-to-dress wounds. - can also be used as a protective layer on non-exuding wounds and/or large areas of fragile skin e.g Epidermolysis Bullosa patients.

Intended patient population:

- **Silicone Hydrocellular Dressings** is suitable for all patient populations especially in people:

- With fragile skin, including young children and the elderly.
- Experiencing pain at dressing changes.
- In whom it is important to protect at-risk peri wound skin.

Intended users:

- Silicone Hydrocellular Dressings can be used by healthcare professional or lay persons under supervision of health care professionals.

- In order to minimize the risk of potential infection hazard or environmental pollution, disposing the medical device should follow disposal procedures according to applicable local laws.

Performance characteristics:

- Soft silicone dressings are coated with a hydrophobic soft silicone layer that is tacky to touch. These dressings do not stick to the moist wound bed but will adhere gently to the surrounding skin. They are designed to minimize trauma on removal and do not leave an adhesive residue on the skin.

- Foam dressings are made from a polyurethane base and are permeable to both gases and water vapor. Their hydrophilic properties allow high absorptive properties while they also provide thermal insulation. Foam dressings also provide a cushioning action that allows pressure relief for patients subjected to long hospitalization periods. This creates a prophylactic indication for pressure injuries.

Silicone Hydrocellular Dressings

- It provides moisture balance to wounds as: moist wound environment hastens the healing of both acute and chronic wounds and promotes the growth of new tissue. A balanced moist wound environment facilitates cellular growth and collagen proliferation within a healthy noncellular matrix. The identified factors in chronic wound fluid that can delay healing have been clarified recently, allowing for a better understanding of ideal conditions for repair. The balance of moisture is critical to wound healing. In acute wounds, a balanced moist surface facilitates the action of growth factors, cytokines, and chemokines, thus promoting cellular growth and the establishment of a provisional wound matrix.

- **Espuma® Gentle Transfer** provides a cushioning and thermal insulation for pain relief. The porous foam membrane allows passage of wound exudates to a secondary absorptive dressing minimizing the pain and discomfort experienced by patient during primary dressing change.

A description of other devices, which are intended to be used in combination with it:

- Silicone Hydrocellular dressings can be used on dry/necrotic wounds in combination with hydrogels (Cavidagel®) as a primary dressing.
- Silicone Hydrocellular dressings can be used on heavily exuding wounds in combination with hydrofibres (Fibrosol® Extra non-adhesive) as a primary dressing.
- Silicone Hydrocellular dressings can be used under compression bandaging (Gauza®) as a secondary dressing.
- Silicone Hydrocellular dressings can be used in combination with Fixation tapes.
- Espuma gentle transfer shall be used with a secondary absorptive dressing (Exsorb®) as a secondary dressing.

Instructions for Use:

1. Cleanse the wound in accordance with local clinical protocols.
2. Dry the surrounding skin thoroughly.
3. Select an appropriate dressing size that overlaps the wound margin by at least two centimeters.
4. Remove the sterile dressing from the package using aseptic technique.

For variants with no adhesive border:

1. Variants with no adhesive border can be cut to fit awkward areas. When used under compression therapy, the dressing must be cut to the size of the wound.
2. Remove the release liner and then place the dressing on the wound site.
3. Secondary film dressing or conforming bandage should be used to secure the dressing in place.
4. For ESPUMA® GENTLE TRANSFER, secure with a secondary absorptive dressing.

For variants with adhesive border:

1. Remove the large flap of the release liner to expose the adhesive portion of the dressing.
2. Position the dressing into place.
4. Slowly remove the small liner flap while smoothing down around the dressing to ensure good adhesion. Do not stretch the dressing.

Instruction of device change:

Dressing change frequency will depend on patient condition as well as wound exudate level. Change dressing when reached its maximum exudate management level or as instructed by a healthcare professional. It Can remain in place for up to 7 days depending on wound condition and exudate level.

Instruction of change:

- Dressing change frequency will depend on patient condition as well as wound exudate level. Change dressing when reached its maximum exudate management level or as instructed by a healthcare professional.
- To remove an adhesive dressing, loosen the adhesive film border before lifting the dressing away from the wound.
- To remove non-adhesive dressing, gently lift the corners of the dressing away from the wound.
- Cleanse the wound prior to application of new dressing.

Precautions change/application:

- Any active bleeding at the insertion site should be stabilized before applying the dressing.
- Do not stretch the dressing during application. Mechanical skin trauma may result if the dressing is applied with tension.
- The skin should be dry and free of detergent residue to prevent skin irritation and to ensure good adhesion.
- Antimicrobial ointments containing polyethylene glycols may compromise the strength of the cover dressing film.
- Use care and cover the port dressing to protect from water when showering.

Silicone Hydrocellular Dressings

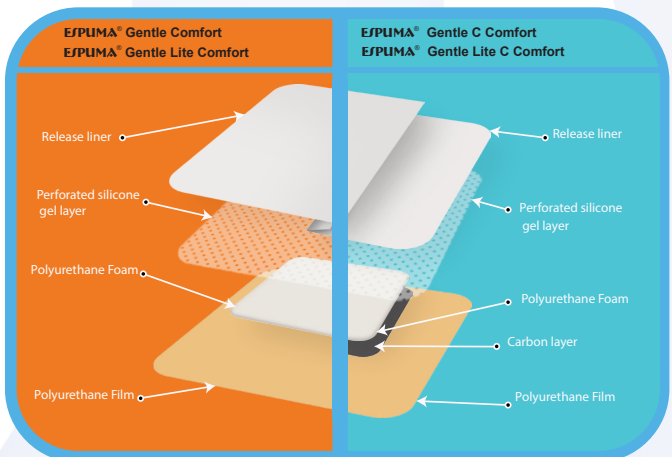
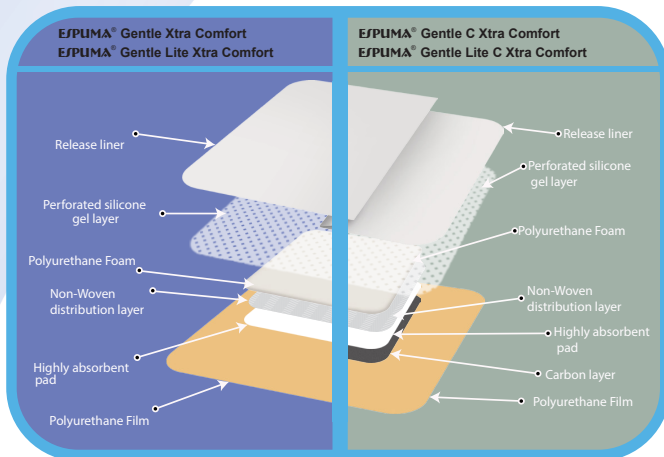
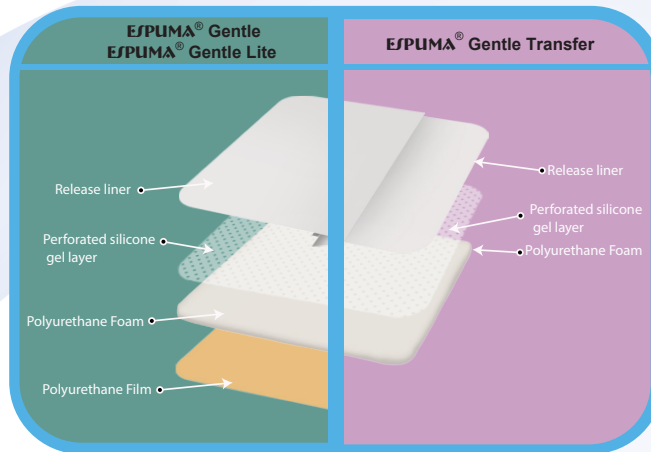

ESPUMA® GENTLE with no adhesive border variants

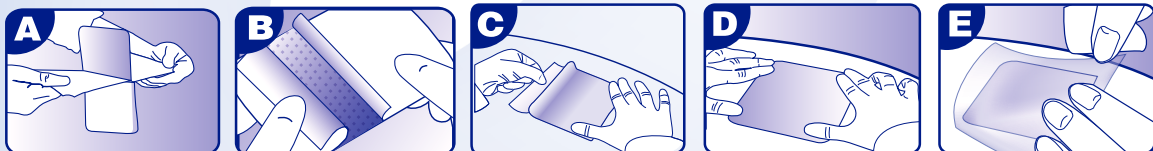

ESPUMA® GENTLE with adhesive border variants

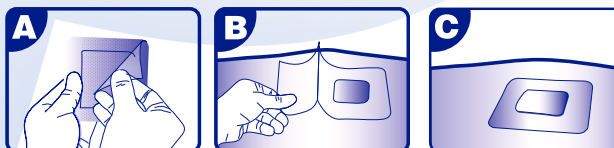

ESPUMA® GENTLE with adhesive border variants (Sacral)

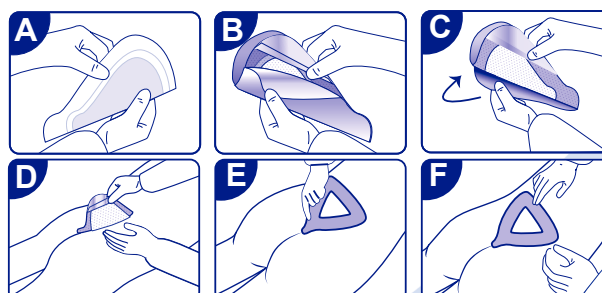

Silicone Hydrocellular Dressings

ESPUMA® Gentle	Size	Pieces/Box	Boxes/Case	Case Dimensions
ESPG7575	75 x 75 mm	10	48	
ESPG75100	75 x 100 mm	10	48	
ESPG100100	100 x 100 mm	10	48	
ESPG150150	150 x 150 mm	5	24	
ESPG100200	100 x 200 mm	5	24	
ESPG100250	100 x 250 mm	5	24	
ESPG100300	100 x 300 mm	5	24	
ESPG125125	125 x 125 mm	5	24	
ESPG130200	130 x 200 mm	5	24	
ESPG175175	175 x 175 mm	3	24	
ESPG150200	150 x 200 mm	3	24	
ESPG200200	200 x 200 mm	3	24	
ESPG200300	200 x 300 mm	3	24	
ESPG200500	200 x 500 mm	10	48	
ESPG6080T	60 x 80 mm Tracheostomy	10	48	
ESPG6565T	65 x 65 mm Tracheostomy	10	48	
ESPG8080T	80 x 80 mm Tracheostomy	10	48	
ESPG8090T	80 x 90 mm Tracheostomy	3	24	
ESPG165180C	165 x 180 mm Concave	3	24	
ESPG170170S	170 x 170 mm Small Sacral	3	24	
ESPG220220S	220 x 220 mm Sacral	3	24	
ESPG220220	220 x 220 mm	3	24	
ESPG5050	50x50 mm	10	48	
ESPG100120	100x120 mm	5	24	
ESPG100150	100 x 150 mm	5	24	
ESPG100350	100x350 mm	5	24	
ESPG200400	200x400 mm	3	24	
ESPG50	50Ø mm	10	48	
ESPG100	100Ø mm	10	48	
ESPG120130H	120x130 mm heel	3	24	
ESPG100125	100x125 mm	5	24	
ESPG200250	200x250 mm	3	24	
ESPG6060	60x60mm	10	48	
ESPG5070	50x70 mm	10	48	
ESPG5060	50x60mm	3	24	
ESPG7585	75x85 mm	5	24	
ESPG200500S	200x500 mm Sacral	5	24	
ESPG6085	60x85 mm	3	24	
ESPG130200H	130x200 mm heel	3	48	
ESPG140150	140x150 mm	5	24	

- Amria - Alexandria - Egypt

Tel. : 002 03 4500264 Fax : 002 03 4500263

- Kafr-El-Zayat P.O.Box 38 Egypt

Tel. : 002 040 2545643 Fax : 002 040 2545645

E-mail : sales@pharmaplast-online.com

Pharmaplast

www.pharmaplast-online.com

Silicone Hydrocellular Dressings

ESPUMA® GENTLE LITE	Size	Pieces/Box	Boxes/Case	Case Dimensions
ESPGL7575	75 x 75 mm	10	48	
ESPGL75100	75 x 100 mm	10	48	
ESPGL100100	100 x 100 mm	10	48	
ESPGL150150	150 x 150 mm	5	24	
ESPGL100200	100 x 200 mm	5	24	
ESPGL100250	100 x 250 mm	5	24	
ESPGL100300	100 x 300 mm	5	24	
ESPGL125125	125 x 125 mm	5	24	
ESPGL130200	130 x 200 mm	5	24	
ESPGL175175	175 x 175 mm	3	24	
ESPGL150200	150 x 200 mm	3	24	
ESPGL200200	200 x 200 mm	3	24	
ESPGL200300	200 x 300 mm	3	24	
ESPGL200500	200 x 500 mm	10	48	
ESPGL6080T	60 x 80 mm Tracheostomy	10	48	
ESPGL6565T	65 x 65 mm Tracheostomy	10	48	
ESPGL8080T	80 x 80 mm Tracheostomy	10	48	
ESPGL8090T	80 x 90 mm Tracheostomy	3	24	
ESPGL165180C	165 x 180 mm Concave	3	24	
ESPGL170170S	170 x 170 mm Small Sacral	3	24	
ESPGL220220S	220 x 220 mm Sacral	3	24	
ESPGL220220	220 x 220 mm	3	24	
ESPGL5050	50x50 mm	10	48	
ESPGL100120	100x120 mm	5	24	
ESPGL100150	100 x 150 mm	5	24	
ESPGL100350	100x350 mm	5	24	
ESPGL200400	200x400 mm	3	24	
ESPGL50	50Ø mm	10	48	
ESPGL100	100Ø mm	10	48	
ESPGL120130	120x130 mm heel	3	24	
ESPGL100125	100x125 mm	5	24	
ESPGL200250	200x250 mm	3	24	
ESPGL6060	60x60 mm	10	48	
ESPGL5070	50x70 mm	10	48	
ESPGL5060	50x60mm	3	24	
ESPGL7585	75x85 mm	5	24	
ESPGL200500S	200x500 mm Sacral	5	24	
ESPGL6085	60x85 mm	3	24	
ESPGL130200H	130x200 mm heel	3	48	
ESPGL140150	140x150 mm	5	24	

Silicone Hydrocellular Dressings

ESPUMA® Gentle Transfer	Size	Pieces/Box	Boxes/Case	Case Dimensions
ESPGT7575	75 x 75 mm	10	48	
ESPGT75100	75 x 100 mm	10	48	
ESPGT100100	100 x 100 mm	10	48	
ESPGT150150	150 x 150 mm	5	24	
ESPGT100200	100 x 200 mm	5	24	
ESPGT100250	100 x 250 mm	5	24	
ESPGT100300	100 x 300 mm	5	24	
ESPGT125125	125 x 125 mm	5	24	
ESPGT130200	130 x 200 mm	5	24	
ESPGT175175	175 x 175 mm	5	24	
ESPGT150200	150 x 200 mm	3	24	
ESPGT200200	200 x 200 mm	3	24	
ESPGT200300	200 x 300 mm	3	24	
ESPGT200500	200 x 500 mm	3	24	
ESPGT6080T	60 x 80 mm Tracheostomy	10	48	
ESPGT6565T	65 x 65 mm Tracheostomy	10	48	
ESPGT8080T	80 x 80 mm Tracheostomy	10	48	
ESPGT8090T	80 x 90 mm Tracheostomy	10	48	
ESPGT165180C	165 x 180 mm Concave	3	24	
ESPGT170170S	170 x 170 mm Small Sacral	3	24	
ESPGT220220S	220 x 220 mm Sacral	3	24	
ESPGT220220	220 x 220 mm	3	24	
ESPGT5050	50x50 mm	10	48	
ESPGT100120	100x120 mm	5	24	
ESPGT100150	100 x 150 mm	5	24	
ESPGT100350	100x350 mm	5	24	
ESPGT200400	200x400 mm	3	24	
ESPGT50	50Ø mm	10	48	
ESPGT100	100Ø mm	10	48	
ESPGT120130	120x130 mm heel	3	24	
ESPGT100125	100x125 mm	5	24	
ESPGT200250	200x250 mm	3	24	
ESPGT6060	60x60 mm	10	48	
ESPGT5070	50x70 mm	5	24	
ESPGT5060	50x60mm	5	24	
ESPGT7585	75x85 mm	5	24	
ESPGT200500S	200x500 mm Sacral	3	24	
ESPGT6085	60x85 mm	10	48	
ESPGT130200H	130x200 mm heel	10	48	
ESPGT140150	140x150 mm	5	24	

Silicone Hydrocellular Dressings

ESPUMA® GENTLE COMFORT	Size	Pieces/Box	Boxes/Case	Case Dimensions
ESPGC7575	75x75 mm	10	48	
ESPGC75100	75x100 mm	10	48	
ESPGC100100	100x100 mm	10	48	
ESPGC100150	100x150 mm	5	24	
ESPGC100200	100x200 mm	5	24	
ESPGC100250	100x250 mm	5	24	
ESPGC100300	100x300 mm	5	24	
ESPGC125125	125x125 mm	5	24	
ESPGC150150	150x150 mm	5	24	
ESPGC150200	150x200 mm	3	24	
ESPGC200200	200x200 mm	3	24	
ESPGC200300	200x300 mm	3	24	
ESPGC165180C	165x180 mm Concave	3	24	
ESPGC170170S	170x170 mm Small Sacral	3	24	
ESPGC220220S	220x220 mm Sacral	3	24	
ESPGC220220	220x220 mm	3	24	
ESPGC5050	50x50 mm	10	48	
ESPGC100120	100x120 mm	5	24	
ESPGC100350	100x350 mm	5	24	
ESPGC200400	200x400 mm	3	24	
ESPGC8090T	80x90 mm Tracheostomy	10	48	
ESPGC50	50Ø mm	10	48	
ESPGC100	100Ø mm	10	48	
ESPGC120130H	120x130 mm heel	3	24	
ESPGC100125	100x125 mm Oval	5	24	
ESPGC175200	175x200 mm	3	24	
ESPGC250300	250x300 mm	3	24	
ESPGC6060	60x60 mm	3	24	
ESPGC150175	150x175 mm	10	48	
ESPGC175175	175x175 mm	5	24	
ESPGC225225	225x225 mm	3	24	
ESPGC250250	250x250 mm	3	24	
ESPGC225225H	225x225 mm heel	3	24	
ESPGC250250H	250x250 mm heel	3	24	
ESPGC225250	225x250 mm	3	24	
ESPGC220250S	220x250 mm Sacral	3	24	
ESPGC6080	60x80 mm	10	48	

Silicone Hydrocellular Dressings

ESPUMA® GENTLE COMFORT	Size	Pieces/Box	Boxes/Case	Case Dimensions
ESPGC180180	180x180 mm	5	24	
ESPGC4565	5x65 mm	10	48	
ESPGC50125	50x125 mm	5	24	
ESPGC4050	40x50 mm	10	48	
ESPGC60120	60x120 mm	5	24	
ESPGC90150	90x150 mm	5	24	
ESPGC175230	175x230 mm	3	24	
ESPGC7585	75x85 mm	10	48	
ESPGC160200S	160x200 mm sacral	3	24	
ESPGC168171S	168x171 mm sacral	3	24	
ESPGC216230S	216x230 mm sacral	3	24	
ESPGC220230H	220x230 mm heel	3	24	
ESPGC185240H	185x240 mm heel	3	24	
ESPGC230232H	230x232 mm heel	3	24	
ESPGC7595	75x95 mm oval	10	48	
ESPGC135165	135x165 mm oval	3	24	
ESPGC160200	160x200 mm oval	3	24	
ESPGC171179	171x179 mm multisite	3	24	
ESPGC140150	140x150 mm	5	24	
ESPGC200500	200x500 mm	3	24	
ESPGC105125	105x125 mm oval	5	24	
ESPGC100300H	100x300 mm heel	5	24	
ESPGC7585H	75x85 mm heel	10	48+	

Silicone Hydrocellular Dressings

ESPUMA® GENTLE LITE COMFORT	Size	Pieces/Box	Boxes/Case	Case Dimensions
ESPGCL7575	75x75 mm	10	48	
ESPGCL75100	75x100 mm	10	48	
ESPGCL100100	100x100 mm	10	48	
ESPGCL100150	100x150 mm	5	24	
ESPGCL100200	100x200 mm	5	24	
ESPGCL100250	100x250 mm	5	24	
ESPGCL100300	100x300 mm	5	24	
ESPGCL125125	125x125 mm	5	24	
ESPGCL150150	150x150 mm	5	24	
ESPGCL150200	150x200 mm	3	24	
ESPGCL200200	200x200 mm	3	24	
ESPGCL200300	200x300 mm	3	24	
ESPGCL165180C	165x180 mm Concave	3	24	
ESPGCL170170S	170x170 mm Small Sacral	3	24	
ESPGCL220220S	220x220 mm Sacral	3	24	
ESPGCL220220	220x220 mm	10	48	
ESPGCL5050	50x50 mm	5	24	
ESPGCL100120	100x120 mm	5	24	
ESPGCL100350	100x350 mm	3	24	
ESPGCL200400	200x400 mm	3	24	
ESPGCL8090T	80x90 mm Tracheostomy	10	48	
ESPGCL50	50Ø mm	10	48	
ESPGCL100	100Ø mm	10	48	
ESPGCL120130H	120x130 mm heel	3	24	
ESPGCL100125	100x125 mm Oval	5	24	
ESPGCL175200	175x200 mm	3	24	
ESPGCL250300	250x300 mm	3	24	
ESPGCL6060	60x60 mm	10	48	
ESPGCL150175	150x175 mm	5	24	
ESPGCL175175	175x175 mm	5	24	
ESPGCL225225	225x225 mm	3	24	
ESPGCL250250	250x250 mm	3	24	
ESPGCL225225H	225x225 mm heel	3	24	
ESPGCL250250H	250x250 mm heel	3	24	
ESPGCL225250	225x250 mm	3	24	
ESPGCL220250S	220x250 mm Sacral	3	24	
ESPGCL6080	60x80 mm	10	48	

Silicone Hydrocellular Dressings

ESPUMA® GENTLE LITE COMFORT	Size	Pieces/Box	Boxes/Case	Case Dimensions
ESPGCL180180	180x180 mm	5	24	
ESPGCL4565	45x65 mm	10	48	
ESPGCL50125	50x125 mm	5	24	
ESPGCL4050	40x50 mm	10	48	
ESPGCL60120	60x120 mm	5	24	
ESPGCL90150	90x150 mm	5	24	
ESPGCL175230	175x230 mm	5	24	
ESPGCL7585	75x85 mm	5	24	
ESPGCL160200S	160x200 mm sacral	3	24	
ESPGCL168171S	168x171 mm sacral	3	24	
ESPGCL216230S	216x230 mm sacral	3	24	
ESPGCL220230H	220x230 mm heel	3	24	
ESPGCL185240H	185x240 mm heel	3	24	
ESPGCL230232H	230x232 mm heel	3	24	
ESPGCL7595	75x95 mm oval	10	48	
ESPGCL135165	135x165 mm oval	3	24	
ESPGCL160200	160x200 mm oval	3	24	
ESPGCL171179	171x179 mm multisite	3	24	
ESPGCL140150	140x150 mm	5	24	
ESPGCL200500	200x500 mm	3	24	
ESPGCL105125	105x125 mm oval	5	24	
ESPGCL100300H	100x300 mm heel	5	24	
ESPGCL7585H	75x85 mm heel	10	48	

Silicone Hydrocellular Dressings

EPUMA® Gentle lite Comfort flex	Size	Pieces/Box	Boxes/Case	Case Dimensions
ESPGCLFLEX7575	75x75 mm	10	48	
ESPGCLFLEX75100	75x100 mm	10	48	
ESPGCLFLEX100100	100x100 mm	10	48	
ESPGCLFLEX100150	100x150 mm	5	24	
ESPGCLFLEX100200	100x200 mm	5	24	
ESPGCLFLEX100250	100x250 mm	5	24	
ESPGCLFLEX100300	100x300 mm	5	24	
ESPGCLFLEX125125	125x125 mm	5	24	
ESPGCLFLEX150150	150x150 mm	5	24	
ESPGCLFLEX150200	150x200 mm	3	24	
ESPGCLFLEX200200	200x200 mm	3	24	
ESPGCLFLEX200300	200x300 mm	3	24	
ESPGCLFLEX165180C	165x180 mm Concave	3	24	
ESPGCLFLEX170170S	170x170 mm Small Sacral	3	24	
ESPGCLFLEX220220S	220x220 mm Sacral	3	24	
ESPGCLFLEX220220	220x220 mm	3	24	
ESPGCLFLEX5050	50x50 mm	3	24	
ESPGCLFLEX100120	100x120 mm	10	48	
ESPGCLFLEX100350	100x350 mm	5	24	
ESPGCLFLEX200400	200x400 mm	3	24	
ESPGCLFLEX8090T	80x90 mm Tracheostomy	10	48	
ESPGCLFLEX50	50Ø mm	10	48	
ESPGCLFLEX100	100Ø mm	10	48	
ESPGCLFLEX120130H	120x130 mm heel	3	24	
ESPGCLFLEX100125	100x125 mm Oval	5	24	
ESPGCLFLEX175200	175x200 mm	3	24	
ESPGCLFLEX250300	250x300 mm	3	24	
ESPGCLFLEX6060	60x60 mm	10	48	
ESPGCLFLEX150175	150x175 mm	5	24	
ESPGCLFLEX175175	175x175 mm	5	24	
ESPGCLFLEX225225	225x225 mm	3	24	
ESPGCLFLEX250250	250x250 mm	3	24	
ESPGCLFLEX225225H	225x225 mm heel	3	24	
ESPGCLFLEX250250H	250x250 mm heel	3	24	
ESPGCLFLEX225250	225x250 mm	3	24	
ESPGCLFLEX220250S	220x250 mm Sacral	3	24	
ESPGCLFLEX6080	60x80 mm	10	48	

Silicone Hydrocellular Dressings

EPUMA® Gentle lite Comfort flex	Size	Pieces/Box	Boxes/Case	Case Dimensions
ESPGCLFLEX180180	180x180 mm	5	24	
ESPGCLFLEX4565	45x65 mm	10	48	
ESPGCLFLEX50125	50x125 mm	5	24	
ESPGCLFLEX4050	40x50 mm	10	48	
ESPGCLFLEX60120	60x120 mm	5	24	
ESPGCLFLEX90150	90x150 mm	5	24	
ESPGCLFLEX175230	175x230 mm	3	24	
ESPGCLFLEX7585	75x85 mm	10	48	
ESPGCLFLEX160200S	160x200 mm sacral	5	24	
ESPGCLFLEX168171S	168x171 mm sacral	3	24	
ESPGCLFLEX216230S	216x230 mm sacral	3	24	
ESPGCLFLEX220230H	220x230 mm heel	3	24	
ESPGCLFLEX185240H	185x240 mm heel	3	24	
ESPGCLFLEX230232H	230x232 mm heel	3	24	
ESPGCLFLEX7595	75x95 mm oval	10	48	
ESPGCLFLEX135165	135x165 mm oval	3	24	
ESPGCLFLEX160200	160x200 mm oval	3	24	
ESPGCLFLEX171179	171x179 mm multisite	3	24	
ESPGCLFLEX140150	140x150 mm	5	24	
ESPGCLFLEX200500	200x500 mm	3	24	
ESPGCLFLEX105125	105x125 mm oval	5	24	
ESPGCLFLEX100300H	100x300 mm heel	3	24	
ESPGCLFLEX7585H	75x85 mm heel	10	48	

Silicone Hydrocellular Dressings

ESPUMA® GENTLE XTRA COMFORT	Size	Pieces/Box	Boxes/Case	Case Dimensions
ESPGCEX7575	75x75 mm	10	48	
ESPGCEX75100	75x100 mm	10	48	
ESPGCEX100100	100x100 mm	10	48	
ESPGCEX100150	100x150 mm	5	24	
ESPGCEX100200	100x200 mm	5	24	
ESPGCEX100250	100x250 mm	5	24	
ESPGCEX100300	100x300 mm	5	24	
ESPGCEX125125	125x125 mm	5	24	
ESPGCEX150150	150x150 mm	5	24	
ESPGCEX150200	150x200 mm	3	24	
ESPGCEX200200	200x200 mm	3	24	
ESPGCEX200300	200x300 mm	3	24	
ESPGCEX165180C	165x180 mm Concave	3	24	
ESPGCEX170170S	170x170 mm Small Sacral	3	24	
ESPGCEX220220S	220x220 mm Sacral	3	24	
ESPGCEX220220	220x220 mm	3	24	
ESPGCEX5050	50x50 mm	10	48	
ESPGCEX100120	100x120 mm	5	24	
ESPGCEX100350	100x350 mm	5	24	
ESPGCEX200400	200x400 mm	3	24	
ESPGCEX8090T	80x90 mm Tracheostomy	10	48	
ESPGCEX50	50Ø mm	10	48	
ESPGCEX100	100Ø mm	10	48	
ESPGCEX120130H	120x130 mm heel	3	24	
ESPGCEX100125	100x125 mm Oval	3	24	
ESPGCEX175200	175x200 mm	3	24	
ESPGCEX250300	250x300 mm	3	24	
ESPGCEX6060	60x60 mm	10	48	
ESPGCEX150175	150x175 mm	5	24	
ESPGCEX175175	175x175 mm	5	24	
ESPGCEX225225	225x225 mm	5	24	
ESPGCEX250250	250x250 mm	3	24	
ESPGCEX225225H	225x225 mm heel	3	24	
ESPGCEX250250H	250x250 mm heel	3	24	
ESPGCEX225250	225x250 mm	3	24	
ESPGCEX220250S	220x250 mm Sacral	3	24	
ESPGCEX6080	60x80 mm	10	48	

Silicone Hydrocellular Dressings

ESPUMA® GENTLE XTRA COMFORT	Size	Pieces/Box	Boxes/Case	Case Dimensions
ESPGCEX180180	180x180 mm	5	24	
ESPGCEX4565	45x65 mm	10	48	
ESPGCEX50125	50x125 mm	5	24	
ESPGCEX4050	40x50 mm	10	48	
ESPGCEX60120	60x120 mm	5	24	
ESPGCEX90150	90x150 mm	5	24	
ESPGCEX175230	175x230 mm	3	24	
ESPGCEX7585	75x85 mm	10	48	
ESPGCEX160200S	160x200 mm sacral	3	24	
ESPGCEX168171S	168x171 mm sacral	3	24	
ESPGCEX216230S	216x230 mm sacral	3	24	
ESPGCEX220230H	220x230 mm heel	3	24	
ESPGCEX185240H	185x240 mm heel	3	24	
ESPGCEX230232H	230x232 mm heel	3	24	
ESPGCEX7595	75x95 mm oval	10	48	
ESPGCEX135165	135x165 mm oval	3	24	
ESPGCEX160200	160x200 mm oval	3	24	
ESPGCEX171179	171x179 mm multisite	3	24	
ESPGCEX140150	140x150 mm	5	24	
ESPGCEX200500	200x500 mm	3	24	
ESPGCEX105125	105x125 mm oval	5	24	
ESPGCEX100300H	100x300 mm heel	5	24	
ESPGCEX7585H	75x85 mm heel	10	48	

Silicone Hydrocellular Dressings

ESPUMA® GENTLE XTRA COMFORT FLEX	Size	Pieces/Box	Boxes/Case	Case Dimensions
ESPGCEXFLEX7575	75x75 mm	10	48	
ESPGCEXFLEX75100	75x100 mm	10	48	
ESPGCEXFLEX100100	100x100 mm	10	48	
ESPGCEXFLEX100150	100x150 mm	5	24	
ESPGCEXFLEX100200	100x200 mm	5	24	
ESPGCEXFLEX100250	100x250 mm	5	24	
ESPGCEXFLEX100300	100x300 mm	5	24	
ESPGCEXFLEX125125	125x125 mm	5	24	
ESPGCEXFLEX150150	150x150 mm	5	24	
ESPGCEXFLEX150200	150x200 mm	3	24	
ESPGCEXFLEX200200	200x200 mm	3	24	
ESPGCEXFLEX200300	200x300 mm	3	24	
ESPGCEXFLEX165180C	165x180 mm Concave	3	24	
ESPGCEXFLEX170170S	170x170 mm Small Sacral	3	24	
ESPGCEXFLEX220220S	220x220 mm Sacral	3	24	
ESPGCEXFLEX220220	220x220 mm	3	24	
ESPGCEXFLEX5050	50x50 mm	10	48	
ESPGCEXFLEX100120	100x120 mm	5	24	
ESPGCEXFLEX100350	100x350 mm	5	24	
ESPGCEXFLEX200400	200x400 mm	3	24	
ESPGCEXFLEX8090T	80x90 mm Tracheostomy	10	48	
ESPGCEXFLEX50	50Ø mm	10	48	
ESPGCEXFLEX100	100Ø mm	10	48	
ESPGCEXFLEX120130H	120x130 mm heel	3	24	
ESPGCEXFLEX100125	100x125 mm Oval	3	24	
ESPGCEXFLEX175200	175x200 mm	3	24	
ESPGCEXFLEX250300	250x300 mm	3	24	
ESPGCEXFLEX6060	60x60 mm	10	48	
ESPGCEXFLEX150175	150x175 mm	5	24	
ESPGCEXFLEX175175	175x175 mm	5	24	
ESPGCEXFLEX225225	225x225 mm	5	24	
ESPGCEXFLEX250250	250x250 mm	3	24	
ESPGCEXFLEX225225H	225x225 mm heel	3	24	
ESPGCEXFLEX250250H	250x250 mm heel	3	24	
ESPGCEXFLEX225250	225x250 mm	3	24	
ESPGCEXFLEX220250S	220x250 mm Sacral	3	24	
ESPGCEXFLEX6080	60x80 mm	10	48	

Silicone Hydrocellular Dressings

ESPUMA® GENTLE XTRA COMFORT FLEX	Size	Pieces/Box	Boxes/Case	Case Dimensions
ESPGCEXFLEX180180	180x180 mm	5	24	
ESPGCEXFLEX4565	45x65 mm	10	48	
ESPGCEXFLEX50125	50x125 mm	5	24	
ESPGCEXFLEX4050	40x50 mm	10	48	
ESPGCEXFLEX60120	60x120 mm	5	24	
ESPGCEXFLEX90150	90x150 mm	5	24	
ESPGCEXFLEX175230	175x230 mm	3	24	
ESPGCEXFLEX7585	75x85 mm	10	48	
ESPGCEXFLEX160200S	160x200 mm sacral	3	24	
ESPGCEXFLEX168171S	168x171 mm sacral	3	24	
ESPGCEXFLEX216230S	216x230 mm sacral	3	24	
ESPGCEXFLEX220230H	220x230 mm heel	3	24	
ESPGCEXFLEX185240H	185x240 mm heel	3	24	
ESPGCEXFLEX230232H	230x232 mm heel	3	24	
ESPGCEXFLEX7595	75x95 mm oval	10	48	
ESPGCEXFLEX135165	135x165 mm oval	3	24	
ESPGCEXFLEX160200	160x200 mm oval	3	24	
ESPGCEXFLEX171179	171x179 mm multisite	3	24	
ESPGCEXFLEX140150	140x150 mm	5	24	
ESPGCEXFLEX200500	200x500 mm	3	24	
ESPGCEXFLEX105125	105x125 mm oval	5	24	
ESPGCEXFLEX100300H	100x300 mm heel	5	24	
ESPGCEXFLEX7585H	75x85 mm heel	10	48	

- Amria - Alexandria - Egypt
 Tel. : 002 03 4500264 Fax : 002 03 4500263
 - Kafr-El-Zayat P.O.Box 38 Egypt
 Tel. : 002 040 2545643 Fax : 002 040 2545645
 E-mail : sales@pharmaplast-online.com

 **Pharmaplast**
 www.pharmaplast-online.com

Pharmaplast Amria 23512, Alexandria - Egypt www.pharmaplast-online.com		Brochure artwork template no: I-TM /AR/001-6 (Version 3)						
Customer : Pharmaplast		Product name : Silicone Hydrocellular Dressings						
Issue date : 27-12-2023		Prepared by : Nader Nabil zaki						
Colors : 		Dimension : A4						
Issue Number	Revision Date	Description of Change	Rationale For Change	Amended by	Effective date	Approved by		
						Artwork manager	Marketing department	RA Department
1	N/A	New Issue	N/A					
2	07/04/2026	Adding missing sizes	file mintance	Nada Youssef	08/04/2026	